

WASTEWATER TREATMENT PLANT FOR 18 PE (no ground water)

Layout

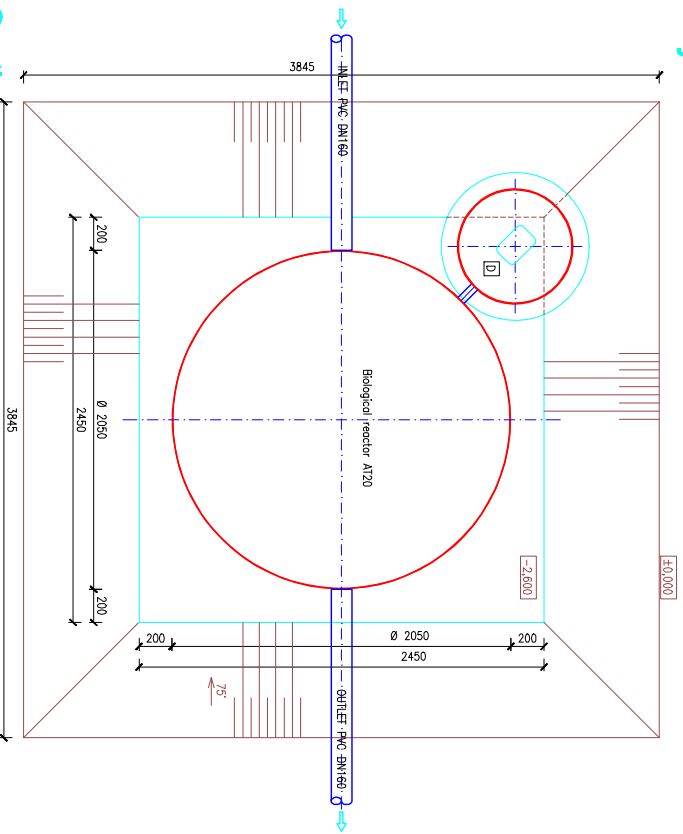

Section

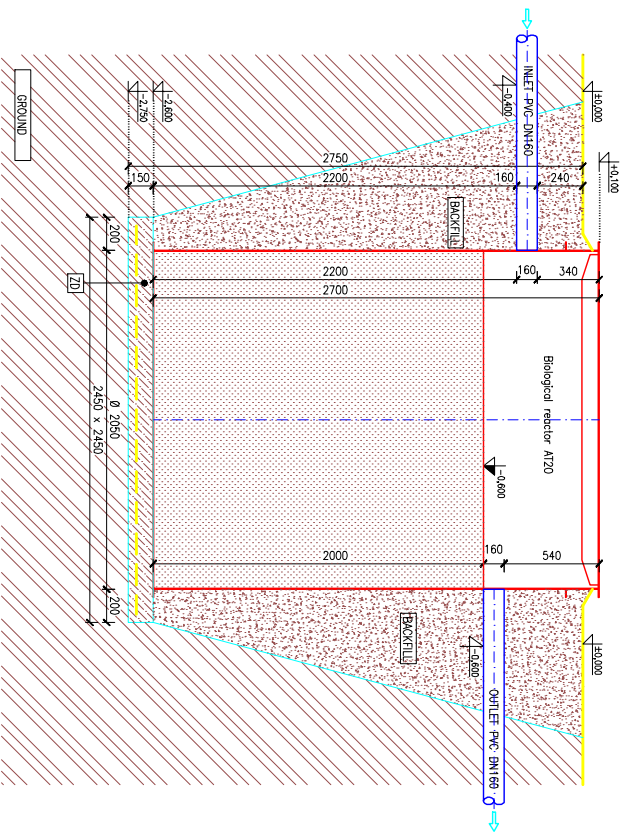

Section

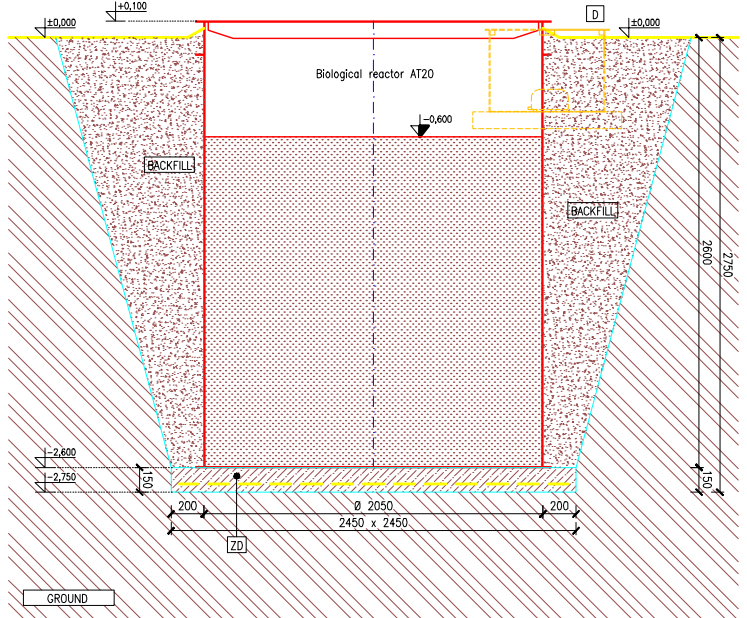

- BACKFILL SAND OR WELL-GRADED GRAVEL, OR USING THE EXCAVATED EARTH FROM THE HOLE WITHOUT OVERSIZE MATERIALS LIKE ROCKS, WITHOUT CLAYS AND HIGHLY ORGANIC SOILS
- Z0 Z0 STEEL REINFORCED CONCRETE SLAB WITH STANDARD MESH (FABRIC Q188 (mesh 150x150 mm, wire #6 mm, concrete strength class B15))
- D TANK FOR BLOWER