

# WASTEWATER TREATMENT PLANT FOR 35 PE (no ground water)

## Layout

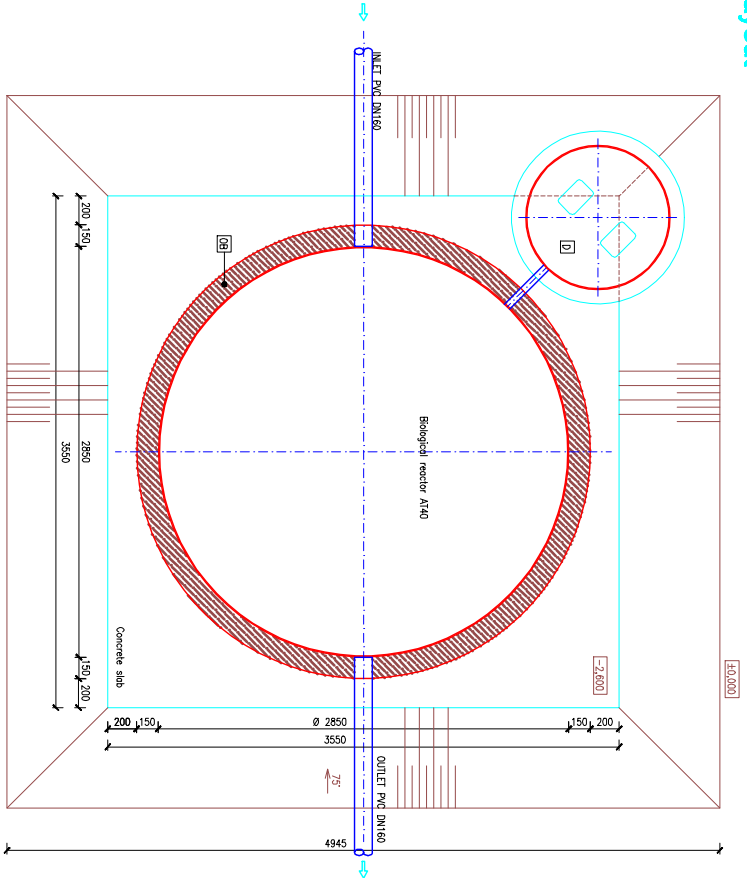

## Section

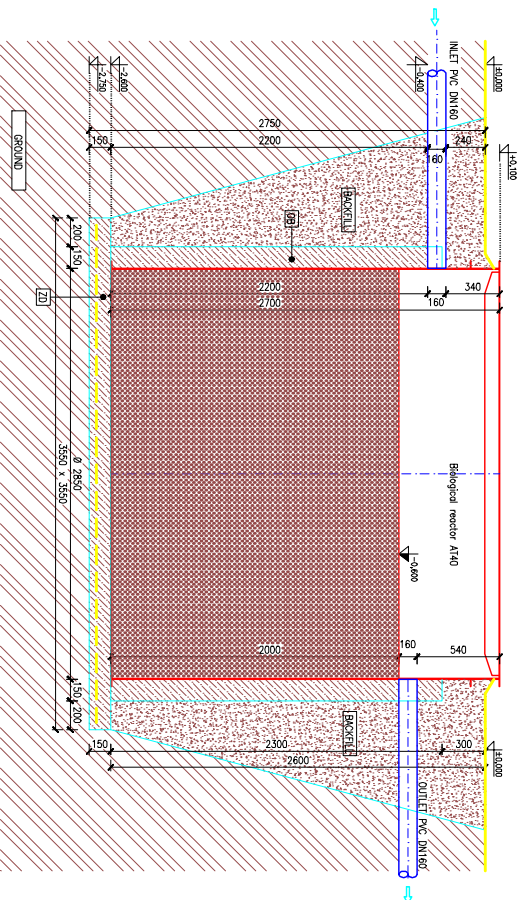

## Section

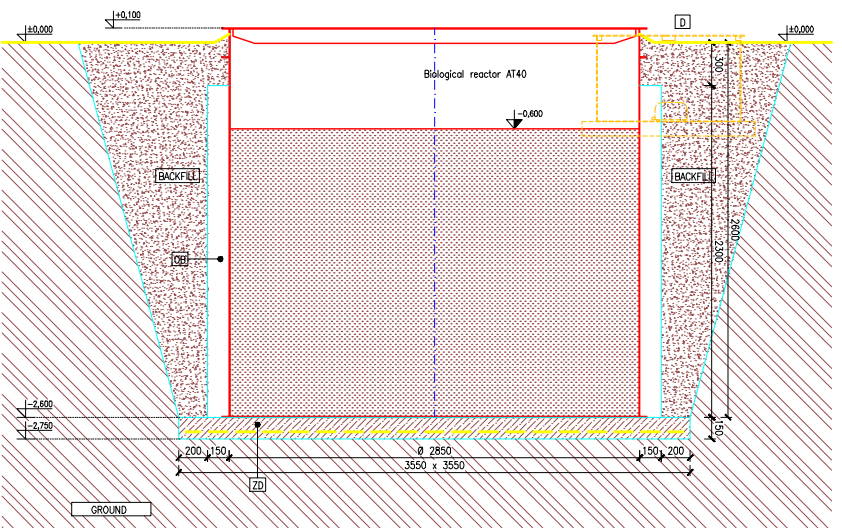

- [BACKFILL] SAND OR WELL-SORTED GRAVEL, OR USING THE EXCAVATED EARTH FROM THE HOLE WITHOUT OVERSIZE MATERIALS LIKE ROCKS, WITHOUT CLAYS AND HIGHLY ORGANIC SOILS
- [B] STEEL REINFORCED CONCRETE SLAB WITH STANDARD MESH FABRIC Ø188 (mesh 150x150 mm, wire ø6 mm, concrete strength class B18)
- [D] CONCRETE CASING OF THE PLASTIC TANK (concrete strength class B15)
- [E] TANK FOR BLOWER